

# Cpro-ECblue

for single phase alternating current, 200-277 V

RH45C-ZIK



## Description

Motor technology: EC  
 Rated voltage U: 1~200-277 V\*  
 Rated frequency f: 50/60 Hz\*  
 Motor input power P: 1.05 kW\*  
 Rated current I: 5.80-4.20 A\*  
 Rated speed n: 1500 min<sup>-1</sup>\*  
 Thermal class: THCL155\*  
 Min. permitted ambient temperature t<sub>R</sub>: -20 °C  
 Max. permitted ambient temperature t<sub>R</sub> at n<sub>max</sub>: 45 °C  
 Electrical connection: integrated Controller  
 Number of blades: 7  
 Balancing quality: G 2.5  
 Protection class: IP54  
 Motor protection: Integrated active temperature management  
 Impeller: ZAmid, uncoated, Ultramarine blue  
 Conformity: ErP 2015, CE  
**ErP-data**  
 Efficiency η<sub>statA</sub>: 68.3 %  
 Efficiency: N<sub>actual</sub> = 78.4 / N<sub>target</sub> = 62\*\*  
 EC controller integrated  
 \*Rated data  
 \*\*ErP 2015

## Characteristic curve

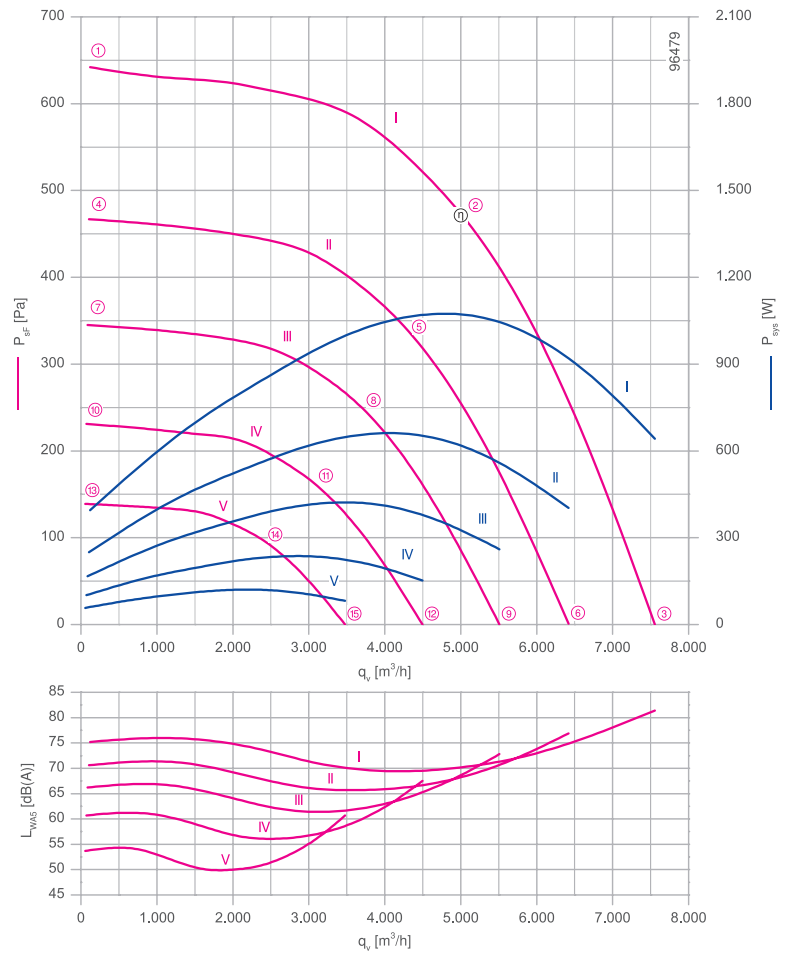

measured with inlet ring, without guard grille according to ISO 5801

➤ Inlet ring	00401298	Page 450
➤ Connection diagram	1360-401	Page 548
➤ Rubber dampers	30x30 / 40	Page 454
➤ Spring vibration dampers	MSN 4	Page 454
➤ System components		Page 448

## Dimensions [mm]

Free-running motor impeller RH in installation position H/u/Vo

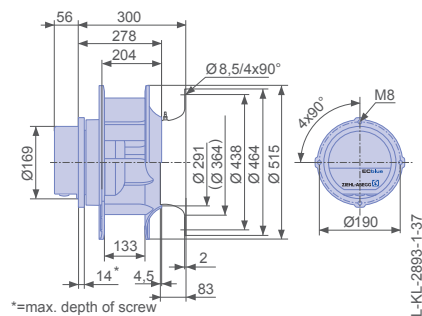

Plug fan ER in installation position H

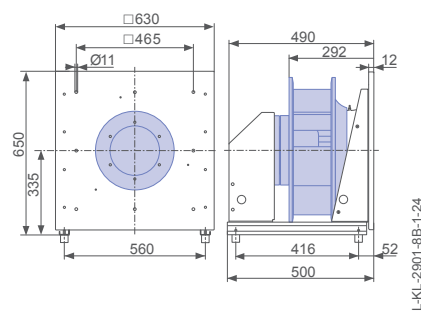

Ventilation unit GR in installation position H

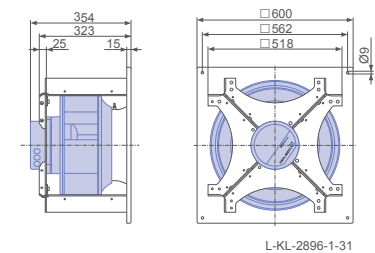

Performance data



Type	Characteristic curve	Speed	Operating point	Current	Motor input power	Suction side sound power level	Maximum ambient temperature
		n [min <sup>-1</sup> ]		I [A]	P <sub>sys</sub> [W]	L <sub>WAS</sub> [dB]	
_45C-ZIK.DC.CR	I	1500	①	1.95	400	75	45
		1500	②	5.00	1050	70	
		1500	③	3.10	640	81	
	II	1280	④	1.15	250	71	60
		1280	⑤	3.20	660	66	
		1280	⑥	1.95	400	77	
	III	1100	⑦	0.78	170	66	
		1100	⑧	2.10	420	62	
		1100	⑨	1.20	260	73	
	IV	900	⑩	0.52	100	61	
		900	⑪	1.10	240	57	
		900	⑫	0.72	150	68	
	V	700	⑬	0.34	60	54	
		700	⑭	0.58	120	51	
		700	⑮	0.44	80	61	

Current values determined at 230V

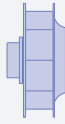
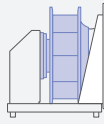
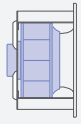
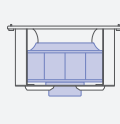
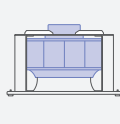
Fan ordering information

Design	RH*	ER**	GR**	GR**	GR**
Installation position	H/Vu/Vo	H	H	Vo	Vu
					
<b>Type</b>	<b>RH45C-ZIK.DC.CR</b>	<b>ER45C-ZIK.DC.CR</b>	<b>GR45C-ZIK.DC.CR</b>	<b>GR45C-ZIK.DC.CR</b>	<b>GR45C-ZIK.DC.CR</b>
Basic electronics					
<b>Article no.</b>	<b>114514</b>	<b>114596/A01</b>	<b>114548/H01</b>	<b>114548/O01</b>	<b>114548/U01</b>
Premium electronics					
<b>Article no.</b>	<b>114515</b>				
Weight [kg]	13.00	33.00	32.00	32.00	32.00
	* Inlet ring not included				
	** Inlet ring integrated				

Control technology

Control module  ➤ Page 464	Operating terminal  ➤ Page 476	Expansion module  ➤ Page 473
---	---	---

Ventilation unit GR in installation position Vo

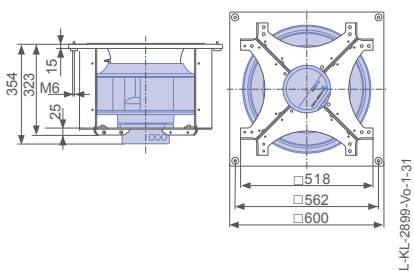

Ventilation unit GR in installation position Vu

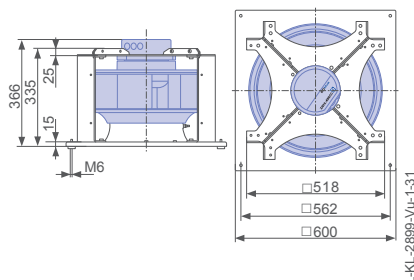

# Cpro-ECblue

for three phase alternating current, 200-240 V

RH45C-ZIK



## Description

Motor technology: EC  
 Rated voltage U: **3-200-240 V\***  
 Rated frequency f: **50/60 Hz\***  
 Motor input power P: **1.65 kW\***  
 Rated current I: **5.20-3.80 A\***  
 Rated speed n: **1750 min<sup>-1</sup>\***  
 Thermal class: **THCL155\***  
 Min. permitted ambient temperature  $t_{R}$ : -20 °C  
 Max. permitted ambient temperature  $t_{R}$  at  $n_{max}$ : 40 °C  
 Electrical connection: integrated Controller  
 Number of blades : 7  
 Balancing quality: G 2.5  
 Protection class: IP54  
 Motor protection: Integrated active temperature management  
 Impeller : ZAmid, uncoated, Ultramarine blue  
 Conformity: ErP 2015, CE

### ErP-data

Efficiency  $\eta_{statA}$ : 69.3 %  
 Efficiency:  $N_{actual} = 77.5 / N_{target} = 62^{**}$   
 EC controller integrated

\*Rated data

\*\*ErP 2015

## Characteristic curve

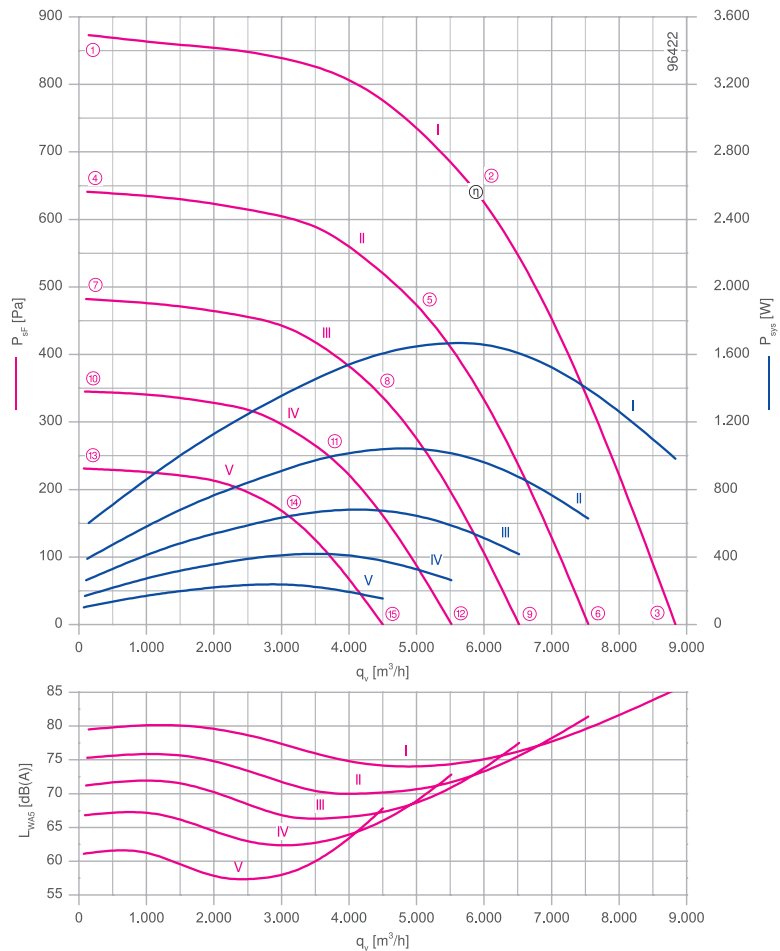

measured with inlet ring, without guard grille according to ISO 5801

➤ Inlet ring	00401298	Page 450
➤ Connection diagram	1360-401	Page 548
➤ Rubber dampers	30x30 / 40	Page 454
➤ Spring vibration dampers	MSN 4	Page 454
➤ System components		Page 448

## Dimensions [mm]

Free-running motor impeller RH in installation position H/u/Vo

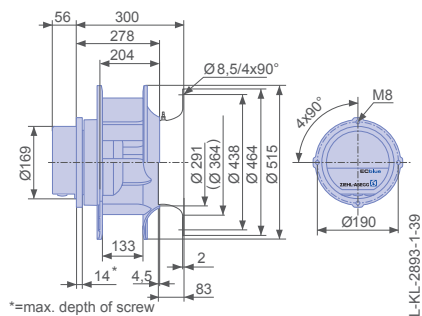

Plug fan ER in installation position H

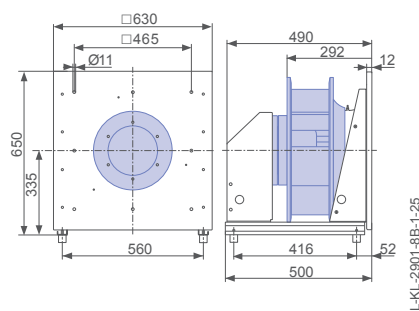

Ventilation unit GR in installation position H

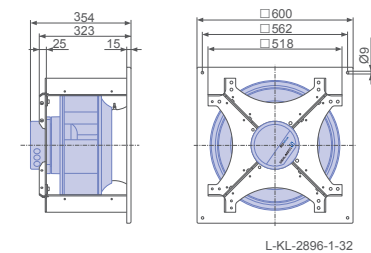

Performance data



Type	Characteristic curve	Speed	Operating point	Current	Motor input power	Suction side sound power level	Maximum ambient temperature
		n [min <sup>-1</sup> ]		I [A]	P <sub>sys</sub> [W]	L <sub>WAS</sub> [dB]	
_45C-ZIK.DC.CR	I	1750	①	1.65	600	80	40
		1750	②	4.40	1650	74	
		1750	③	2.60	980	85	
	II	1500	④	1.10	390	75	60
		1500	⑤	2.80	1050	71	
		1500	⑥	1.70	620	81	
	III	1300	⑦	0.80	260	71	
		1300	⑧	1.85	680	67	
		1300	⑨	1.20	420	78	
	IV	1100	⑩	0.58	170	67	
		1100	⑪	1.20	420	63	
		1100	⑫	0.82	260	73	
	V	900	⑬	0.42	100	61	
		900	⑭	0.74	240	58	
		900	⑮	0.56	150	68	

Current values determined at 230V

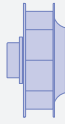
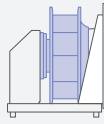
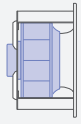
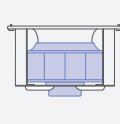
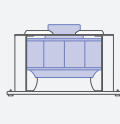
Fan ordering information

Design	RH*	ER**	GR**	GR**	GR**
Installation position	H/Vu/Vo	H	H	Vo	Vu
					
<b>Type</b>	<b>RH45C-ZIK.DC.CR</b>	<b>ER45C-ZIK.DC.CR</b>	<b>GR45C-ZIK.DC.CR</b>	<b>GR45C-ZIK.DC.CR</b>	<b>GR45C-ZIK.DC.CR</b>
Basic electronics					
<b>Article no.</b>	<b>114516</b>	<b>114597/A01</b>	<b>114549/H01</b>	<b>114549/O01</b>	<b>114549/U01</b>
Premium electronics					
<b>Article no.</b>	<b>114517</b>				
Weight [kg]	13.00	33.00	32.00	32.00	32.00
	* Inlet ring not included				
	** Inlet ring integrated				

Control technology

Control module	Operating terminal	Expansion module
		
➤ Page 464	➤ Page 476	➤ Page 473

Ventilation unit GR in installation position Vo

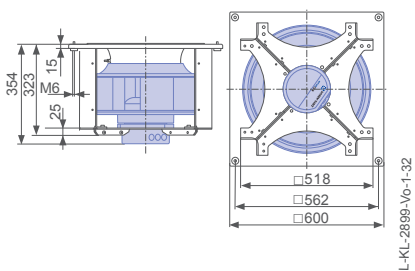

Ventilation unit GR in installation position Vu

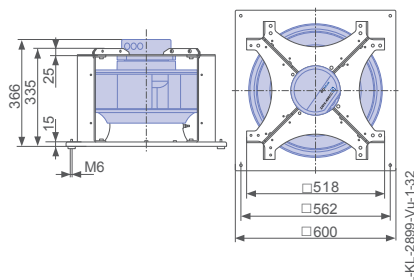



# Cpro-ECblue

for three phase alternating current, 200-240 V

RH45C-ZIK



## Description

Motor technology: EC  
 Rated voltage U: **3-200-240 V\***  
 Rated frequency f: **50/60 Hz\***  
 Motor input power P: **3.60 kW\***  
 Rated current I: **11.00-9.20 A\***  
 Rated speed n: **2260 min<sup>-1</sup>\***  
 Thermal class: **THCL155\***  
 Min. permitted ambient temperature  $t_{r1}$ : -20 °C  
 Max. permitted ambient temperature  $t_{r2}$  at  $n_{max}$ : 55 °C  
 Electrical connection: integrated Controller  
 Number of blades : 7  
 Balancing quality: G 2.5  
 Protection class: IP54  
 Motor protection: Integrated active temperature management  
 Impeller : ZAmid, uncoated, Ultramarine blue  
 Conformity: ErP 2015, CE

### ErP-data

Efficiency  $\eta_{statA}$ : 64.3 %  
 Efficiency:  $N_{actual} = 68.9 / N_{target} = 62^{**}$   
 EC controller integrated

\*Rated data  
 \*\*ErP 2015

## Characteristic curve

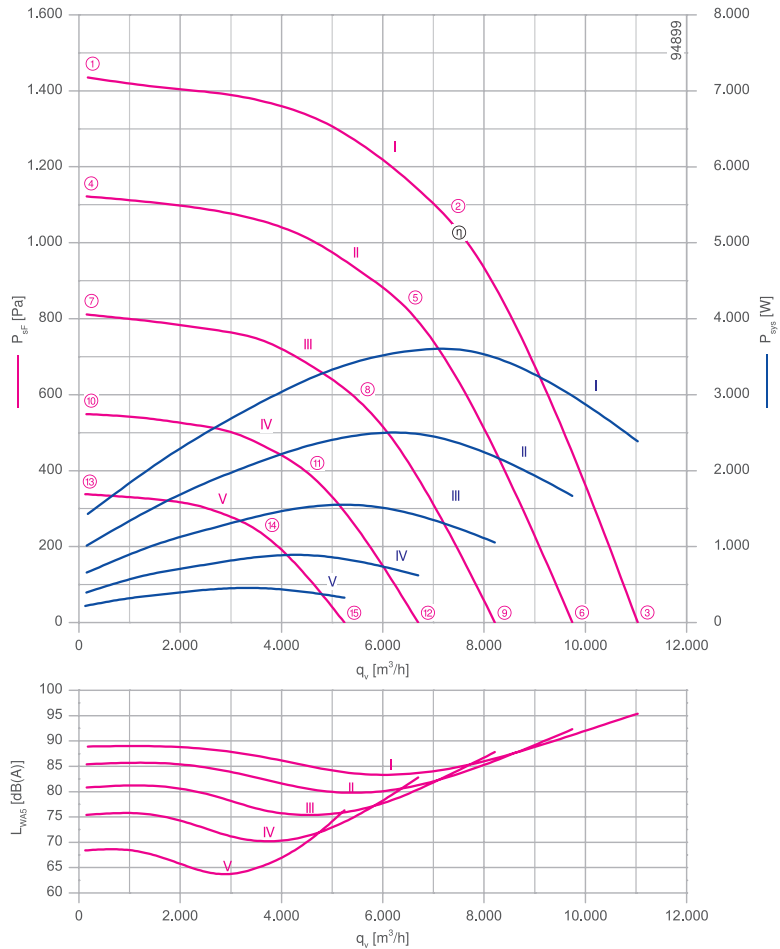

measured with inlet ring, without guard grille according to ISO 5801

➤ Inlet ring	00401298	Page 450
➤ Connection diagram	1360-401	Page 548
➤ Rubber dampers	30x30 / 40	Page 454
➤ Spring vibration dampers	MSN 5	Page 454
➤ System components		Page 448

## Dimensions [mm]

Free-running motor impeller RH in installation position H/V/u/Vo

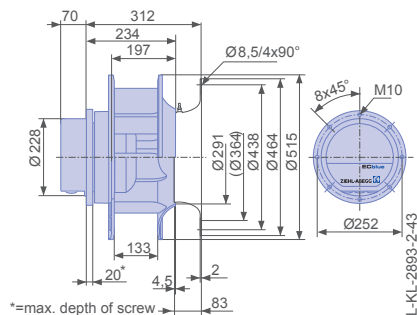

Plug fan ER in installation position H

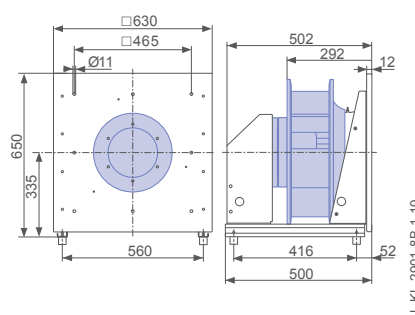

Ventilation unit GR in installation position H

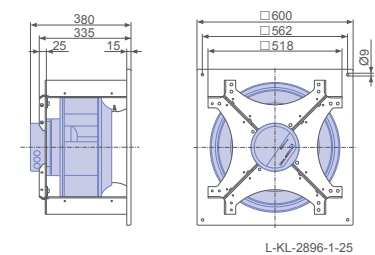

Performance data

Type	Characteristic curve	Speed	Operating point	Current	Motor input power	Suction side sound power level
		n [min <sup>-1</sup> ]		I [A]	P <sub>sys</sub> [W]	L <sub>WA5</sub> [dB]
_45C-ZIK.GG.CR	I	2260	①	3.80	1450	89
		2260	②	9.40	3600	84
		2260	③	6.20	2400	95
	II	2000	④	2.70	1000	85
		2000	⑤	6.60	2500	81
		2000	⑥	4.40	1650	92
	III	1700	⑦	1.75	660	81
		1700	⑧	4.00	1550	76
		1700	⑨	2.80	1050	88
	IV	1400	⑩	1.10	400	75
		1400	⑪	2.40	880	71
		1400	⑫	1.70	620	83
	V	1100	⑬	0.68	220	68
		1100	⑭	1.25	460	65
		1100	⑮	0.94	330	76

Current values determined at 230V

Fan ordering information

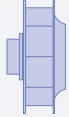
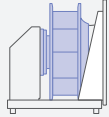
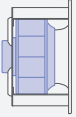
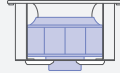
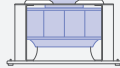
Design	RH*	ER**	GR**	GR**	GR**
Installation position	H/Vu/Vo	H	H	Vo	Vu
					
<b>Type</b>	<b>RH45C-ZIK.GG.CR</b>	<b>ER45C-ZIK.GG.CR</b>	<b>GR45C-ZIK.GG.CR</b>	<b>GR45C-ZIK.GG.CR</b>	<b>GR45C-ZIK.GG.CR</b>
Basic electronics					
<b>Article no.</b>	<b>114609</b>	<b>114665/A01</b>	<b>114645/H01</b>	<b>114645/O01</b>	<b>114645/U01</b>
Premium electronics					
<b>Article no.</b>	<b>114610</b>				
Weight [kg]	22.00	41.00	40.00	40.00	40.00
* Inlet ring not included					
** Inlet ring integrated					

Control technology

Control module	Operating terminal	Expansion module
		
➔ Page 464	➔ Page 476	➔ Page 473

Ventilation unit GR in installation position Vo

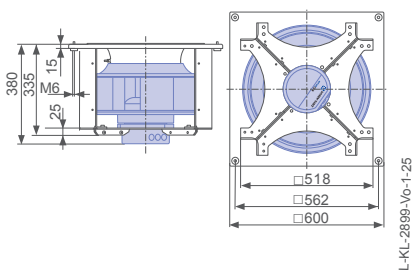

Ventilation unit GR in installation position Vu

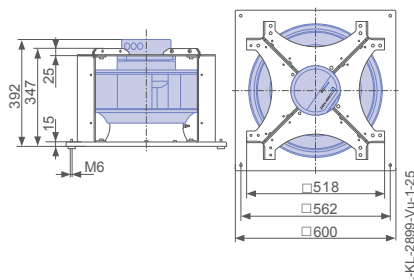

# Cpro-ECblue

for three phase alternating current, 380-480 V

RH45C-ZIK



## Description

Motor technology: EC  
 Rated voltage U: **3-380-480 V\***  
 Rated frequency f: **50/60 Hz\***  
 Motor input power P: **1.80 kW\***  
 Rated current I: **2.90-2.30 A\***  
 Rated speed n: **1800 min<sup>-1</sup>\***  
 Thermal class: **THCL155\***  
 Min. permitted ambient temperature  $t_{r1}$ : -20 °C  
 Max. permitted ambient temperature  $t_{r2}$  at  $n_{max}$ : 40 °C  
 Electrical connection: integrated Controller  
 Number of blades: 7  
 Balancing quality: G 2.5  
 Protection class: IP54  
 Motor protection: Integrated active temperature management  
 Impeller: ZAmid, uncoated, Ultramarine blue  
 Conformity: ErP 2015, CE  
**ErP-data**  
 Efficiency  $\eta_{statA}$ : 69.3 %  
 Efficiency:  $N_{actual} = 77.1 / N_{target} = 62^{**}$   
 EC controller integrated  
 \*Rated data  
 \*\*ErP 2015

## Characteristic curve

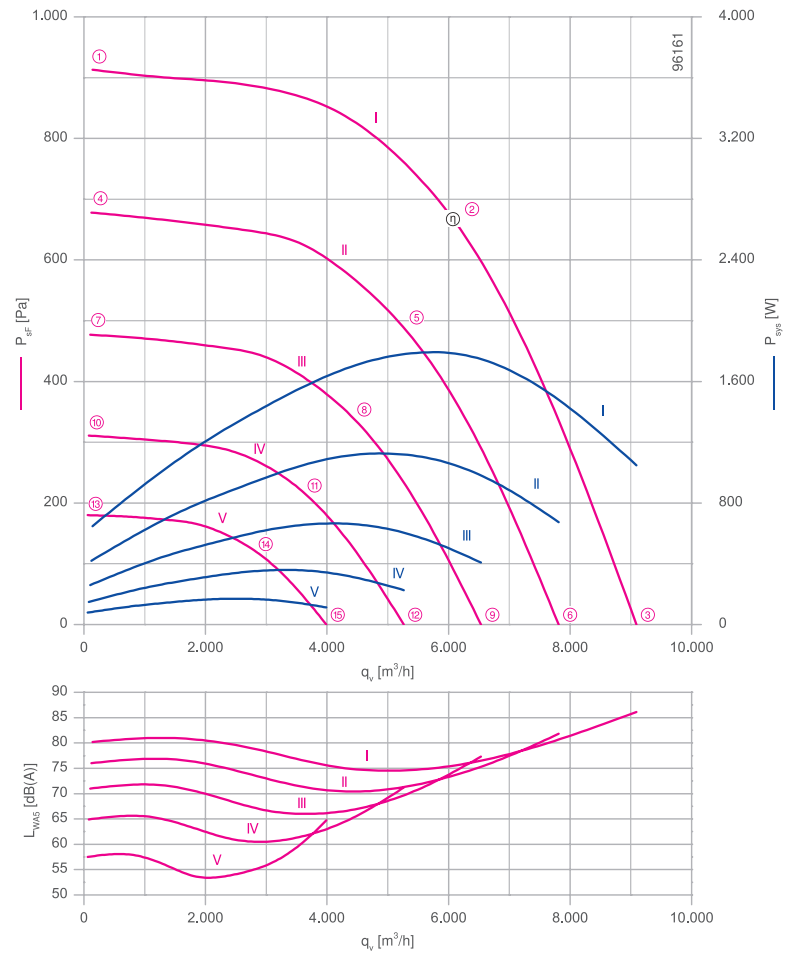

measured with inlet ring, without guard grille according to ISO 5801

➤ Inlet ring	00401298	Page 450
➤ Connection diagram	1360-401	Page 548
➤ Rubber dampers	30x30 / 40	Page 454
➤ Spring vibration dampers	MSN 4	Page 454
➤ System components		Page 448

## Dimensions [mm]

Free-running motor impeller RH in installation position H/u/Vo

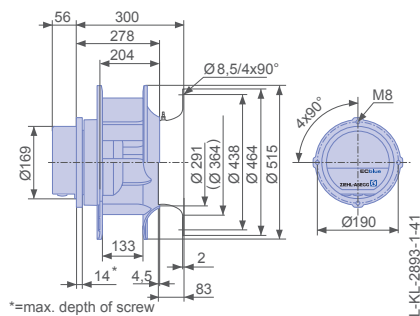

Plug fan ER in installation position H

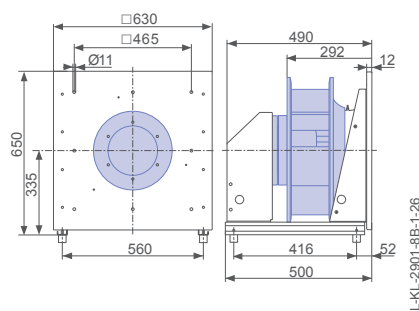

Ventilation unit GR in installation position H

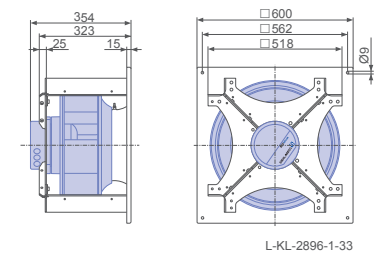

Performance data

Type	Characteristic curve	Speed	Operating point	Current	Motor input power	Suction side sound power level	Maximum ambient temperature
		n [min <sup>-1</sup> ]		I [A]	P <sub>sys</sub> [W]	L <sub>WAS</sub> [dB]	
_45C-ZIK.DC.CR	I	1800	①	1.10	640	80	40
		1800	②	2.70	1800	75	
		1800	③	1.65	1050	86	
	II	1550	④	0.78	420	76	60
		1550	⑤	1.75	1100	71	
		1550	⑥	1.10	680	82	
	III	1300	⑦	0.58	260	71	
		1300	⑧	1.10	660	67	
		1300	⑨	0.76	400	77	
	IV	1050	⑩	0.40	150	65	
		1050	⑪	0.70	360	61	
		1050	⑫	0.52	230	71	
	V	800	⑬	0.28	80	58	
		800	⑭	0.44	170	55	
		800	⑮	0.34	110	65	

Current values determined at 400V

Fan ordering information

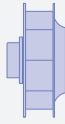
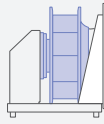
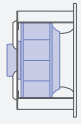
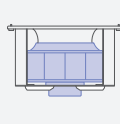
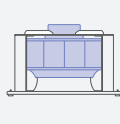
Design	RH*	ER**	GR**	GR**	GR**
Installation position	H/Vu/Vo	H	H	Vo	Vu
					
<b>Type</b>	<b>RH45C-ZIK.DC.CR</b>	<b>ER45C-ZIK.DC.CR</b>	<b>GR45C-ZIK.DC.CR</b>	<b>GR45C-ZIK.DC.CR</b>	<b>GR45C-ZIK.DC.CR</b>
Basic electronics					
<b>Article no.</b>	<b>114518</b>	<b>114598/A01</b>	<b>114550/H01</b>	<b>114550/O01</b>	<b>114550/U01</b>
Premium electronics					
<b>Article no.</b>	<b>114519</b>				
Weight [kg]	13.00	33.00	32.00	32.00	32.00
	* Inlet ring not included				
	** Inlet ring integrated				

Control technology

Control module  ➔ Page 464	Operating terminal  ➔ Page 476	Expansion module  ➔ Page 473
---	---	---

Ventilation unit GR in installation position Vo

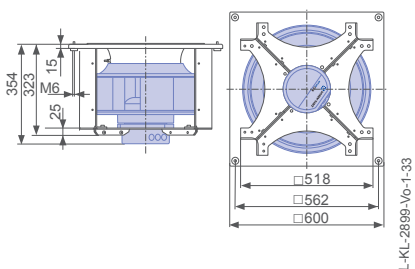

Ventilation unit GR in installation position Vu

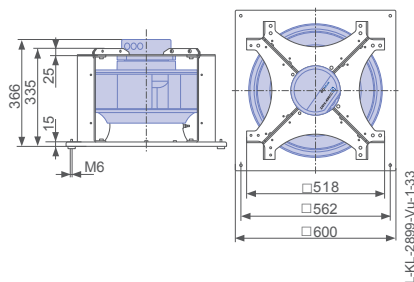

# Cpro-ECblue

for three phase alternating current, 380-480 V

RH45C-ZIK



## Description

Motor technology: EC  
 Rated voltage U: **3-380-480 V\***  
 Rated frequency f: **50/60 Hz\***  
 Motor input power P: **2.00 kW\***  
 Rated current I: **3.30-2.60 A\***  
 Rated speed n: **1880 min<sup>-1</sup>\***  
 Thermal class: **THCL155\***  
 Min. permitted ambient temperature  $t_{r, \min}$ : -20 °C  
 Max. permitted ambient temperature  $t_{r, \max}$ : 45 °C  
 Electrical connection: integrated Controller  
 Number of blades : 7  
 Balancing quality: G 2.5  
 Protection class: IP54  
 Motor protection: Integrated active temperature management  
 Impeller : ZAmid, uncoated, Ultramarine blue  
 Conformity: ErP 2015, CE

### ErP-data

Efficiency  $\eta_{\text{statA}}$ : 69.0 %  
 Efficiency:  $N_{\text{actual}} = 76.3 / N_{\text{target}} = 62^{**}$   
 EC controller integrated

\*Rated data  
 \*\*ErP 2015

## Characteristic curve

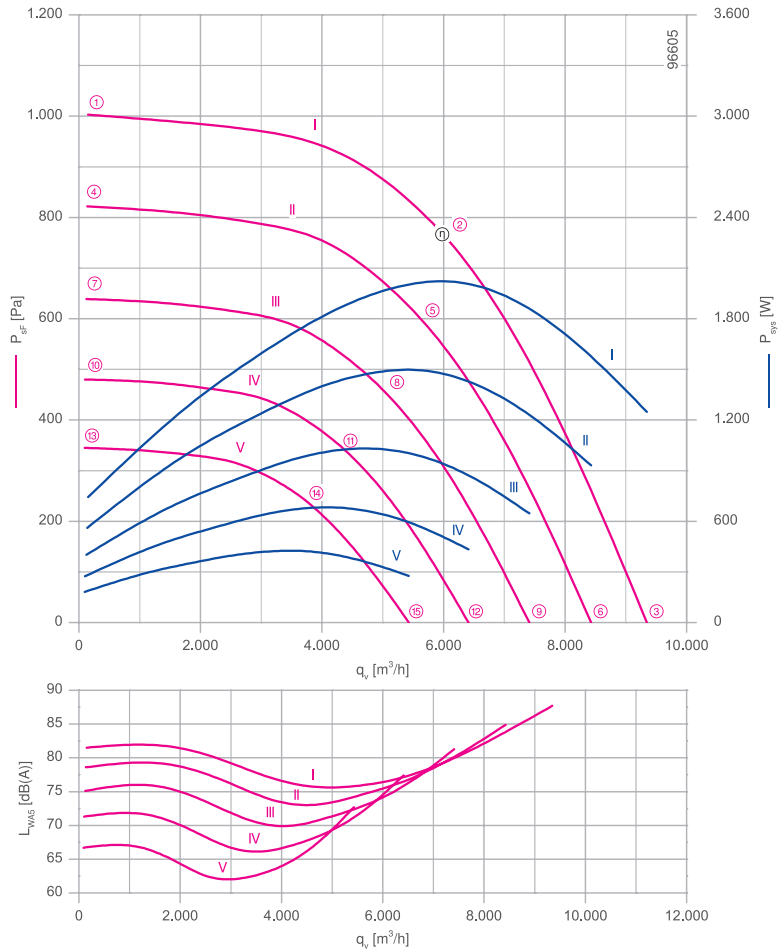

measured with inlet ring, without guard grille according to ISO 5801

➤ Inlet ring	00401298	Page 450
➤ Connection diagram	1360-401	Page 548
➤ Rubber dampers	30x30 / 40	Page 454
➤ Spring vibration dampers	MSN 4	Page 454
➤ System components		Page 448

## Dimensions [mm]

Free-running motor impeller RH  
in installation position H/u/Vo

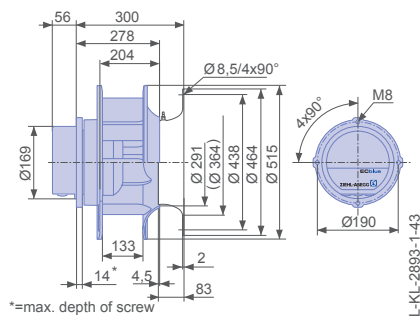

Plug fan ER in installation position H

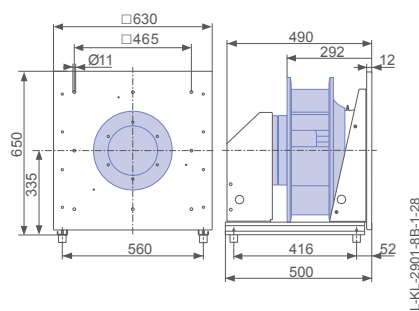

Ventilation unit GR in installation position H

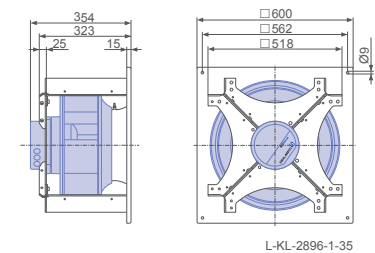

Performance data

Type	Characteristic curve	Speed	Operating point	Current	Motor input power	Suction side sound power level	Maximum ambient temperature
		n [min <sup>-1</sup> ]		I [A]	P <sub>sys</sub> [W]	L <sub>WAS</sub> [dB]	
_45C-ZIK.DG.CR	I	1880	①	1.25	740	82	45
		1880	②	3.10	2000	76	
		1880	③	1.95	1250	88	
	II	1700	④	1.00	560	79	60
		1700	⑤	2.30	1500	75	
		1700	⑥	1.50	940	85	
	III	1500	⑦	0.80	400	75	
		1500	⑧	1.65	1050	71	
		1500	⑨	1.10	640	81	
	IV	1300	⑩	0.62	270	71	
		1300	⑪	1.15	680	67	
		1300	⑫	0.84	440	77	
	V	1100	⑬	0.48	180	67	
		1100	⑭	0.82	420	63	
		1100	⑮	0.62	280	73	

Current values determined at 400V

Fan ordering information

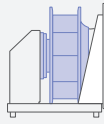
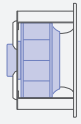
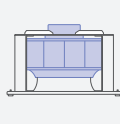
Design	RH*	ER**	GR**	GR**	GR**
Installation position	H/Vu/Vo	H	H	Vo	Vu
					
<b>Type</b>	<b>RH45C-ZIK.DG.CR</b>	<b>ER45C-ZIK.DG.CR</b>	<b>GR45C-ZIK.DG.CR</b>	<b>GR45C-ZIK.DG.CR</b>	<b>GR45C-ZIK.DG.CR</b>
Basic electronics					
<b>Article no.</b>	<b>114522</b>	<b>114600/A01</b>	<b>114552/H01</b>	<b>114552/O01</b>	<b>114552/U01</b>
Premium electronics					
<b>Article no.</b>	<b>114523</b>				
Weight [kg]	13.00	35.00	33.00	33.00	33.00
* Inlet ring not included					
** Inlet ring integrated					

Control technology

Control module  ➤ Page 464	Operating terminal  ➤ Page 476	Expansion module  ➤ Page 473
---	---	---

Ventilation unit GR in installation position Vo

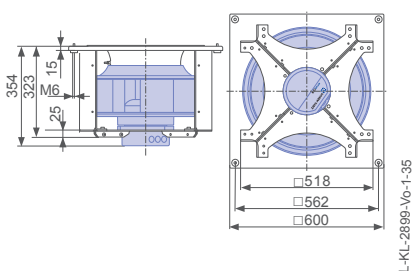

Ventilation unit GR in installation position Vu

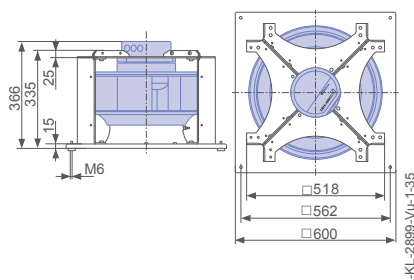

# Cpro-ECblue

for three phase alternating current, 380-480 V

RH45C-ZIK



## Description

Motor technology: EC  
 Rated voltage U: **3-380-480 V\***  
 Rated frequency f: **50/60 Hz\***  
 Motor input power P: **3.50 kW\***  
 Rated current I: **5.80-4.60 A\***  
 Rated speed n: **2260 min<sup>-1</sup>\***  
 Thermal class: **THCL155\***  
 Min. permitted ambient temperature  $t_{r1}$ : -20 °C  
 Max. permitted ambient temperature  $t_{r2}$  at  $n_{max}$ : 55 °C  
 Electrical connection: integrated Controller  
 Number of blades : 7  
 Balancing quality: G 2.5  
 Protection class: IP54  
 Motor protection: Integrated active temperature management  
 Impeller : ZAmid, uncoated, Ultramarine blue  
 Conformity: ErP 2015, CE

### ErP-data

Efficiency  $\eta_{statA}$ : 64.2 %  
 Efficiency:  $N_{actual} = 68.9 / N_{target} = 62^{**}$   
 EC controller integrated

\*Rated data  
 \*\*ErP 2015

## Characteristic curve

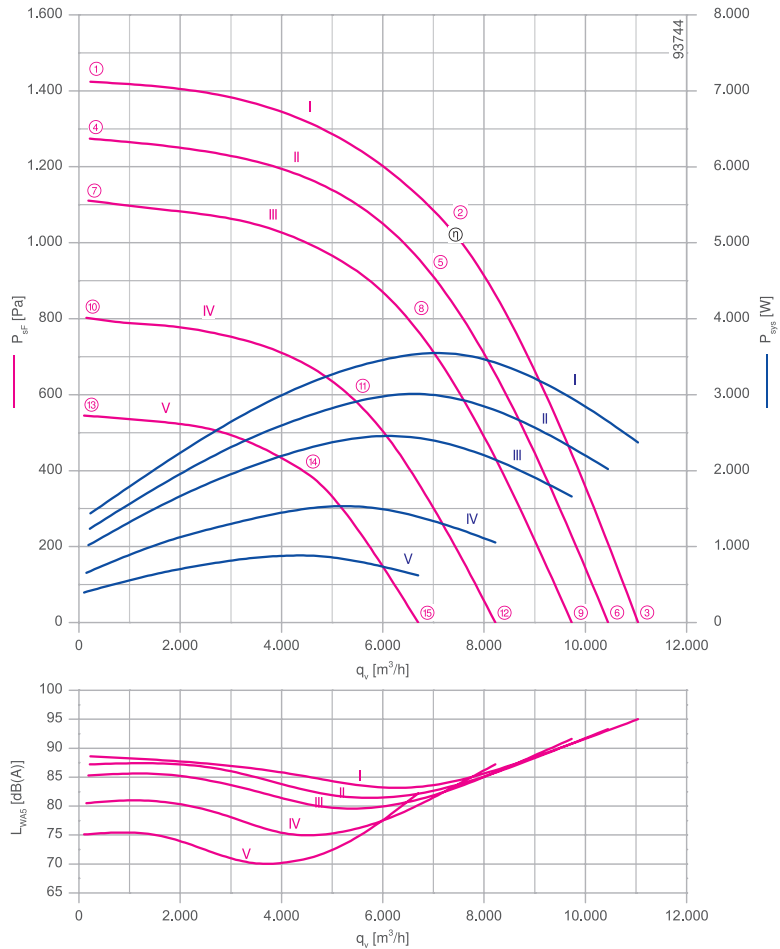

measured with inlet ring, without guard grille according to ISO 5801

➤ Inlet ring	00401298	Page 450
➤ Connection diagram	1360-401	Page 548
➤ Rubber dampers	30x30 / 40	Page 454
➤ Spring vibration dampers	MSN 5	Page 454
➤ System components		Page 448

## Dimensions [mm]

Free-running motor impeller RH  
in installation position H/Vu/Vo

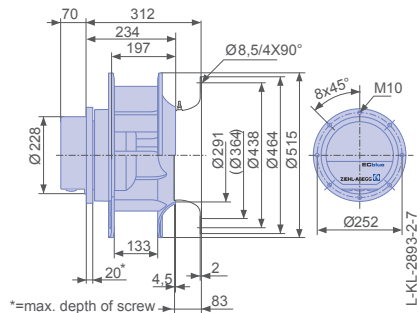

Plug fan ER in installation position H

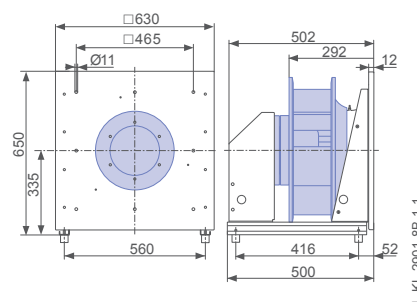

Ventilation unit GR in installation position H

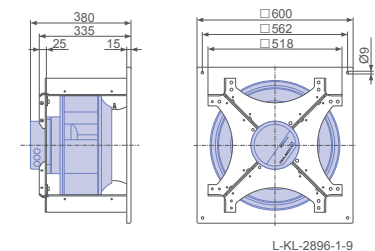

Performance data

Type	Characteristic curve	Speed	Operating point	Current	Motor input power	Suction side sound power level	Maximum ambient temperature
		n [min <sup>-1</sup> ]		I [A]	P <sub>sys</sub> [W]	L <sub>WAS</sub> [dB]	
_45C-ZIK.GG.CR	I	2260	①	2.30	1450	89	55
		2260	②	5.40	3500	84	
		2260	③	3.60	2400	95	
	II	2140	④	1.95	1250	87	60
		2140	⑤	4.60	3000	82	
		2140	⑥	3.10	2000	93	
	III	2000	⑦	1.65	1000	85	
		2000	⑧	3.80	2500	80	
		2000	⑨	2.60	1650	92	
	IV	1700	⑩	1.15	660	81	
		1700	⑪	2.40	1550	76	
		1700	⑫	1.70	1050	87	
	V	1400	⑬	0.82	400	75	
		1400	⑭	1.45	880	70	
		1400	⑮	1.10	620	82	

Current values determined at 400V

Fan ordering information

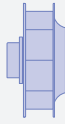
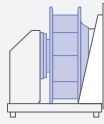
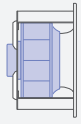
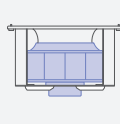
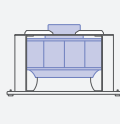
Design	RH*	ER**	GR**	GR**	GR**
Installation position	H/Vu/Vo	H	H	Vo	Vu
					
<b>Type</b>	<b>RH45C-ZIK.GG.CR</b>	<b>ER45C-ZIK.GG.CR</b>	<b>GR45C-ZIK.GG.CR</b>	<b>GR45C-ZIK.GG.CR</b>	<b>GR45C-ZIK.GG.CR</b>
Basic electronics					
<b>Article no.</b>	<b>114611</b>	<b>114666/A01</b>	<b>114646/H01</b>	<b>114646/O01</b>	<b>114646/U01</b>
Premium electronics					
<b>Article no.</b>	<b>114612</b>				
Weight [kg]	22.00	41.00	40.00	40.00	40.00
* Inlet ring not included					
** Inlet ring integrated					

Control technology

Control module  ➔ Page 464	Operating terminal  ➔ Page 476	Expansion module  ➔ Page 473
---	---	---

Ventilation unit GR in installation position Vo

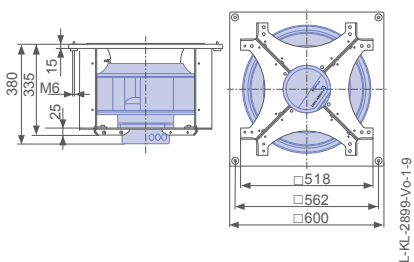

Ventilation unit GR in installation position Vu

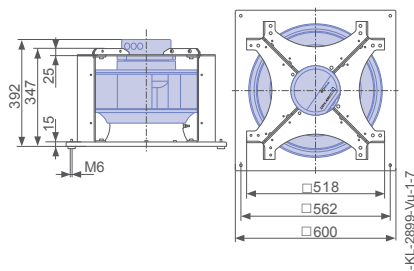



# Cpro-ECblue

for three phase alternating current, 380-480 V

RH45C-ZIK



## Description

Motor technology: EC  
 Rated voltage U: **3-380-480 V\***  
 Rated frequency f: **50/60 Hz\***  
 Motor input power P: **5,20 kW\***  
 Rated current I: **8.40-6.60 A\***  
 Rated speed n: **2570 min<sup>-1</sup>\***  
 Thermal class: **THCL155\***  
 Min. permitted ambient temperature  $t_{r1}$ : -20 °C  
 Max. permitted ambient temperature  $t_{r2}$  at  $n_{max}$ : 40 °C  
 Electrical connection: integrated Controller  
 Number of blades : 7  
 Balancing quality: G 2.5  
 Protection class: IP54  
 Motor protection: Integrated active temperature management  
 Impeller : ZAmid, uncoated, Ultramarine blue  
 Conformity: ErP 2015, CE

### ErP-data

Efficiency  $\eta_{statA}$ : 63.3 %  
 Efficiency:  $N_{actual} = 66.3 / N_{target} = 62^{**}$   
 EC controller integrated

\*Rated data

\*\*ErP 2015

## Characteristic curve

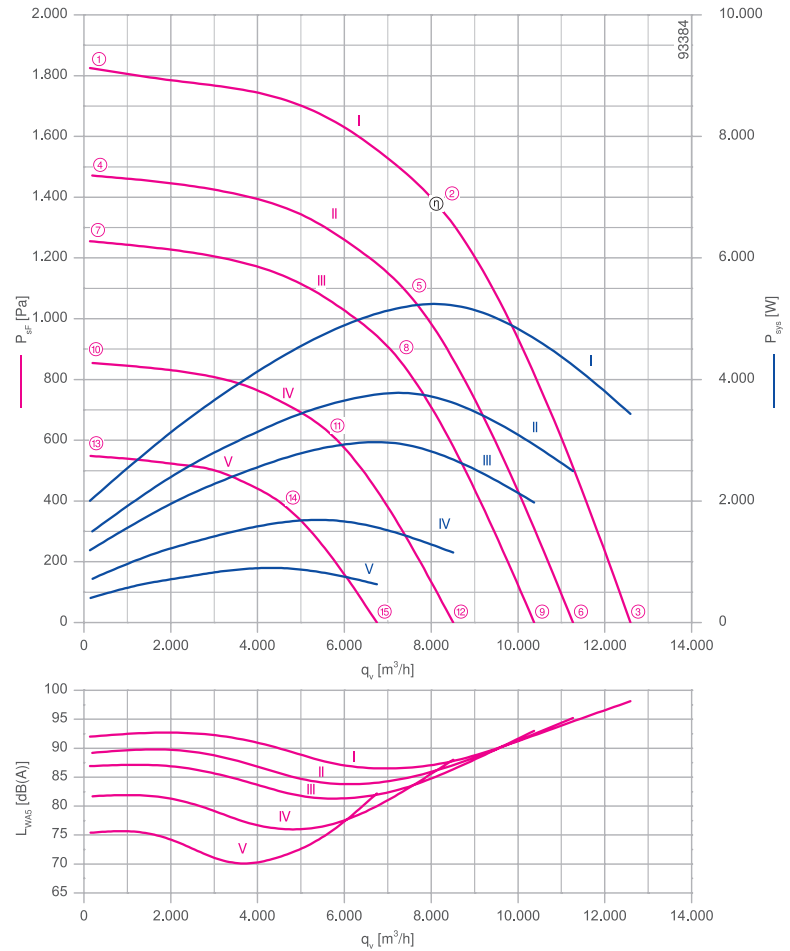

measured with inlet ring, without guard grille according to ISO 5801

➤ Inlet ring	00401298	Page 450
➤ Connection diagram	1360-401	Page 548
➤ Rubber dampers	30x30 / 40	Page 454
➤ Spring vibration dampers	MSN 5	Page 454
➤ System components		Page 448

## Dimensions [mm]

Free-running motor impeller RH  
in installation position H/V/u/Vo

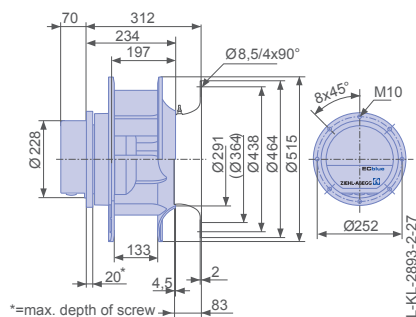

Plug fan ER in installation position H

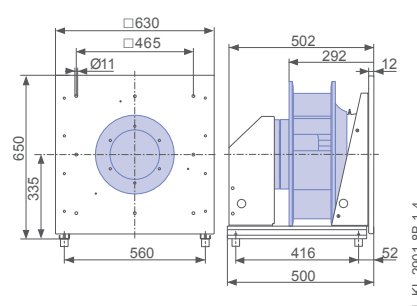

Ventilation unit GR in installation position H

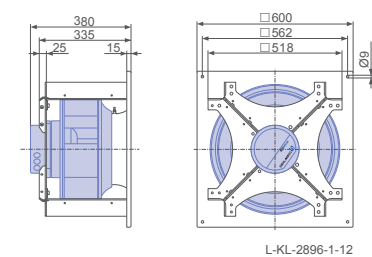

Performance data

Type	Characteristic curve	Speed	Operating point	Current	Motor input power	Suction side sound power level	Maximum ambient temperature
		n [min <sup>-1</sup> ]		I [A]	P <sub>sys</sub> [W]	L <sub>WAS</sub> [dB]	
_45C-ZIK.GG.CR	I	2570	①	3.10	2000	92	40
		2570	②	8.00	5200	87	
		2570	③	5.20	3400	98	
	II	2310	④	2.40	1500	89	60
		2310	⑤	5.80	3800	85	
		2310	⑥	3.80	2500	95	
	III	2130	⑦	1.90	1200	87	
		2130	⑧	4.60	3000	83	
		2130	⑨	3.00	2000	93	
	IV	1760	⑩	1.25	720	82	
		1760	⑪	2.60	1700	77	
		1760	⑫	1.85	1150	88	
	V	1410	⑬	0.84	400	75	
		1410	⑭	1.50	900	71	
		1410	⑮	1.15	620	82	

Current values determined at 400V

Fan ordering information

Design	RH*	ER**	GR**	GR**	GR**	
Installation position	H/Vu/Vo	H	H	Vo	Vu	
						
<b>Type</b>	<b>RH45C-ZIK.GG.CR</b>	<b>ER45C-ZIK.GG.CR</b>	<b>GR45C-ZIK.GG.CR</b>	<b>GR45C-ZIK.GG.CR</b>	<b>GR45C-ZIK.GG.CR</b>	
Basic electronics						
<b>Article no.</b>	<b>114705</b>	<b>114730/A01</b>	<b>114721/H01</b>	<b>114721/O01</b>	<b>114721/U01</b>	
Premium electronics						
<b>Article no.</b>	<b>114706</b>					
Weight [kg]	22.00	41.00	40.00	40.00	40.00	
* Inlet ring not included						
** Inlet ring integrated						

Control technology

Control module  ➔ Page 464	Operating terminal  ➔ Page 476	Expansion module  ➔ Page 473
---	---	---

Ventilation unit GR in installation position Vo

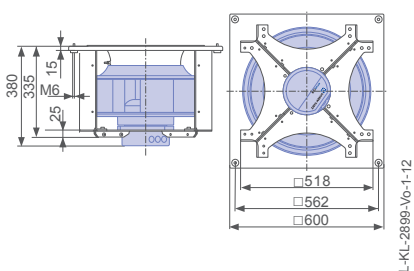

Ventilation unit GR in installation position Vu

