

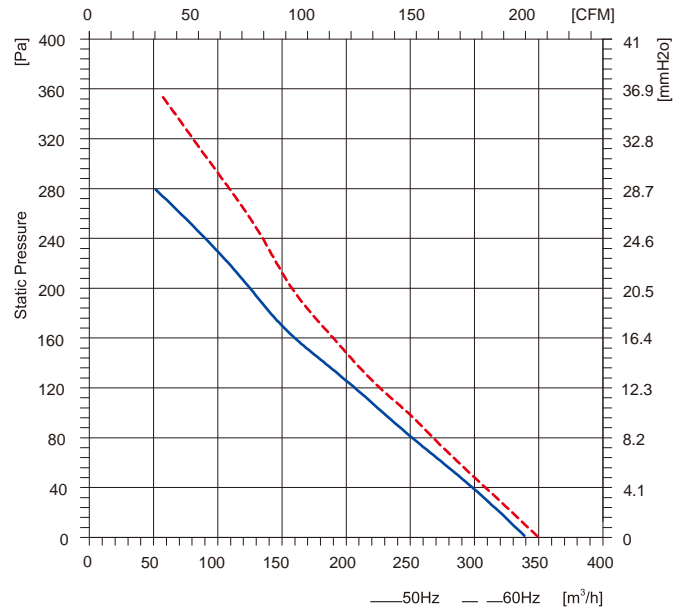

### Flow Rate Curve



### 产品特点

电机技术: AC 外转子  
电机工作制: S1 连续工作制  
电机防护等级: IP54  
电机绝缘等级: F  
轴承: 免维护深沟球轴承  
风轮材料: 塑胶  
外壳材料: 镀锌钢板  
风轮旋向: 逆时针, 从引出线端看过去

### Product Characteristic

Motor technology: AC Outer rotor  
Mode of Operation: S1  
Protection Class: IP54  
Insulation Class: F  
Bearings: Maintenance-free ball bearings  
Impeller Material: Plastic  
Housing Material: Galvanised sheet steel  
Rotation: C.C.W, seen on the leads

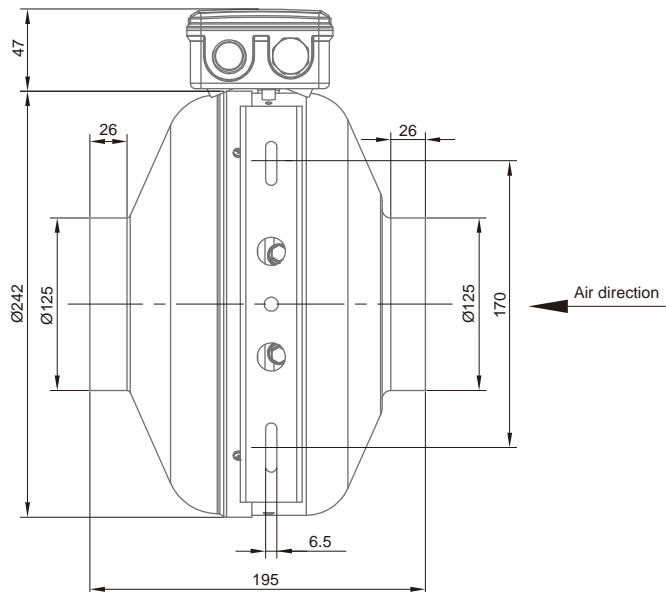
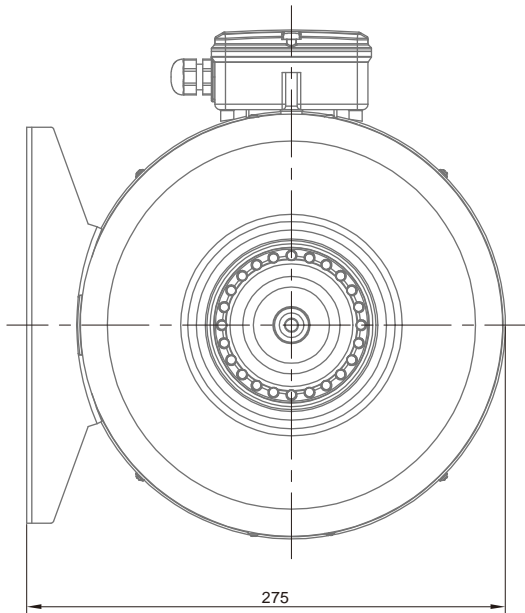

型号 Model	电压 Voltage (V)	频率 Frequency (Hz)	输入功率 Input Power (W)	电流 Current (A)	转速 Speed (r/min)	电容 Capacitor (µF)	允许最高环境温度 Max Environmental Temperature (°C)	重量 Weight (Kg)
YWF(K)2E192-125T	230	50/60	70/90	0.30/0.40	2400/2500	2	70	3.3

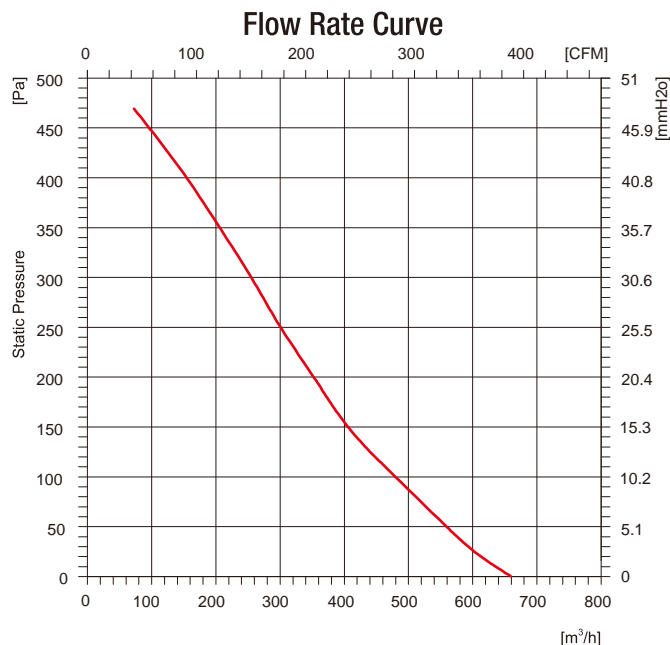

### 产品特点

电机技术: AC 外转子  
 电机工作制: S1 连续工作制  
 电机防护等级: IP54  
 电机绝缘等级: F  
 轴承: 免维护深沟球轴承  
 风轮材料: 塑胶  
 外壳材料: 镀锌钢板  
 风轮旋向: 逆时针, 从引出线端看过去

### Product Characteristic

Motor technology: AC Outer rotor  
 Mode of Operation: S1  
 Protection Class: IP54  
 Insulation Class: F  
 Bearings: Maintenance-free ball bearings  
 Impeller Material: Plastic  
 Housing Material: Galvanised sheet steel  
 Rotation: C.C.W., seen on the leads

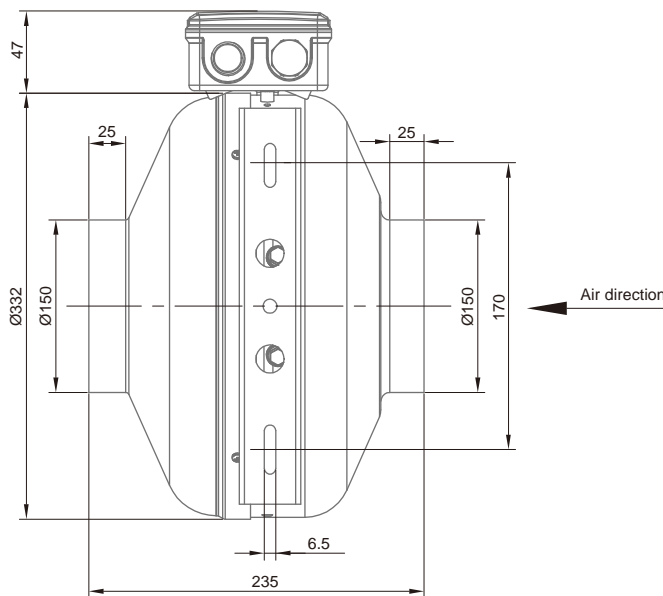
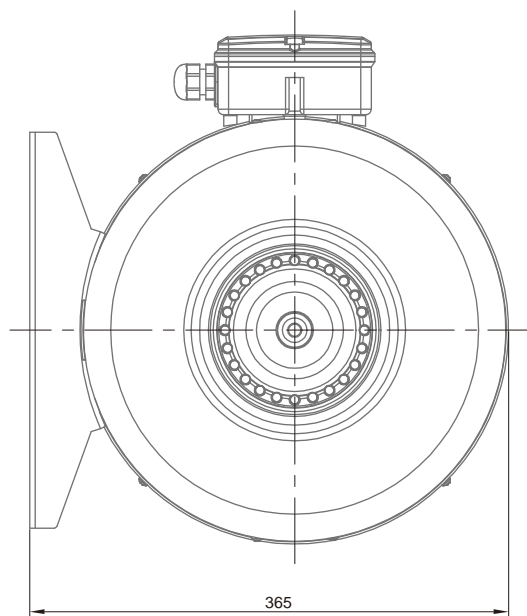

型号 Model	电压 Voltage (V)	频率 Frequency (Hz)	输入功率 Input Power (W)	电流 Current (A)	风量 Air Volume (m³/h)	转速 Speed (r/min)	电容 Capacitor (µF)	噪音 Noise [dB(A)]	允许最高 环境温度 Max Environmental Temperature (°C)	重量 Weight (Kg)
YWF(K)2B220-150T02	120	60	150	1.3	660	2550	12	64	60	4.1

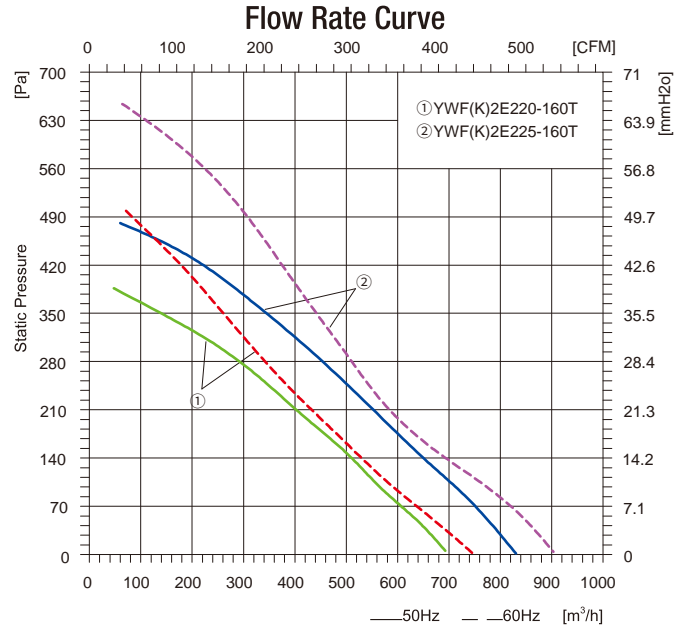

## 产品特点

电机技术: AC 外转子  
 电机工作制: S1 连续工作制  
 电机防护等级: IP54  
 电机绝缘等级: F  
 轴承: 免维护深沟球轴承  
 风轮材料: 塑胶  
 外壳材料: 镀锌钢板  
 风轮旋向: 逆时针, 从引出线端看过去

## Product Characteristic

Motor technology: AC Outer rotor  
 Mode of Operation: S1  
 Protection Class: IP54  
 Insulation Class: F  
 Bearings: Maintenance-free ball bearings  
 Impeller Material: Plastic  
 Housing Material: Galvanised sheet steel  
 Rotation: C.C.W, seen on the leads

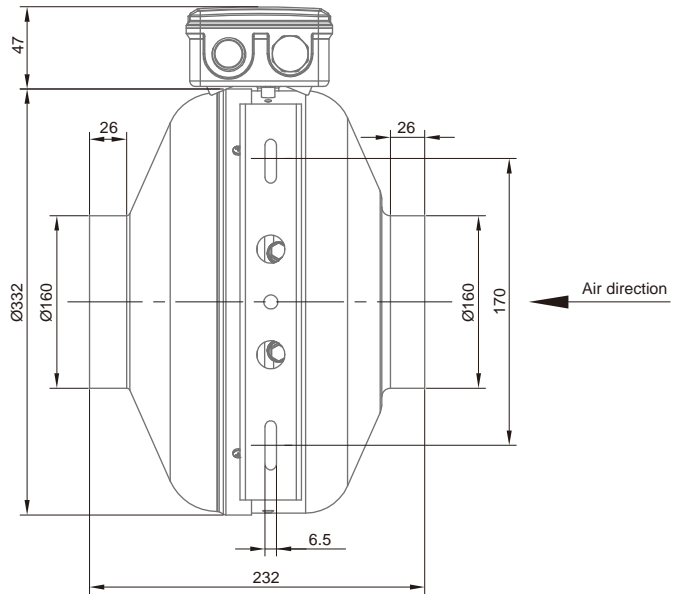
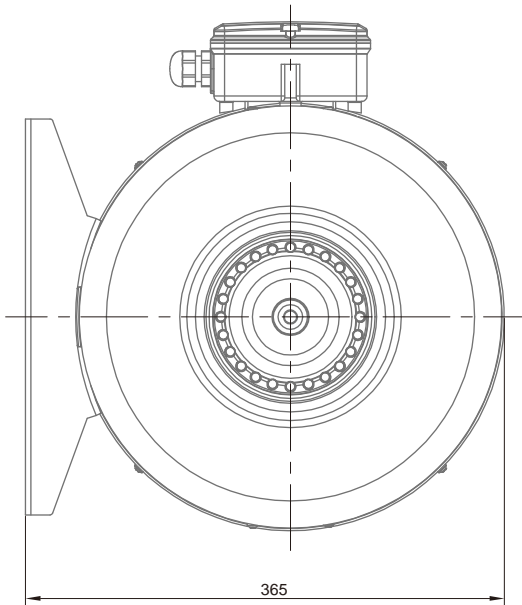

型号 Model	电压 Voltage (V)	频率 Frequency (Hz)	输入功率 Input Power (W)	电流 Current (A)	风量 Air Volume (m³/h)	转速 Speed (r/min)	电容 Capacitor (µF)	噪音 Noise [dB(A)]	允许最高环境温度 Max Environmental Temperature (°C)	重量 Weight (Kg)
YWF(K)2E220-160T	230	50/60	115/150	0.5/0.63	700/750	2550/2820	3	64/66	50	4.2
YWF(K)2E225-160T	230	50/60	150/200	0.7/0.95	830/900	2600/3000	4	66/68	70	4.7

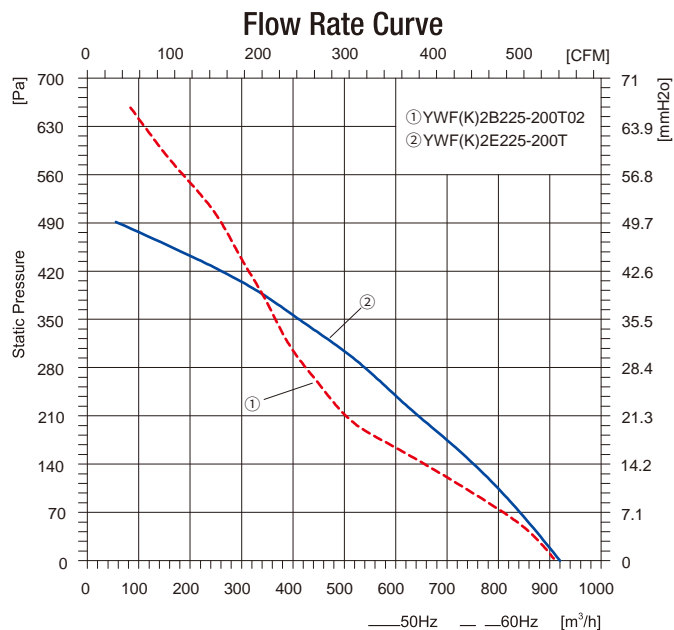

### 产品特点

电机技术: AC 外转子  
 电机工作制: S1 连续工作制  
 电机防护等级: IP54  
 电机绝缘等级: F  
 轴承: 免维护深沟球轴承  
 风轮材料: 镀锌铁  
 外壳材料: 镀锌钢板  
 风轮旋向: 逆时针, 从引出线端看过去

### Product Characteristic

Motor technology: AC Outer rotor  
 Mode of Operation: S1  
 Protection Class: IP54  
 Insulation Class: F  
 Bearings: Maintenance-free ball bearings  
 Impeller Material: Galvanised iron  
 Housing Material: Galvanised sheet steel  
 Rotation: C.C.W, seen on the leads

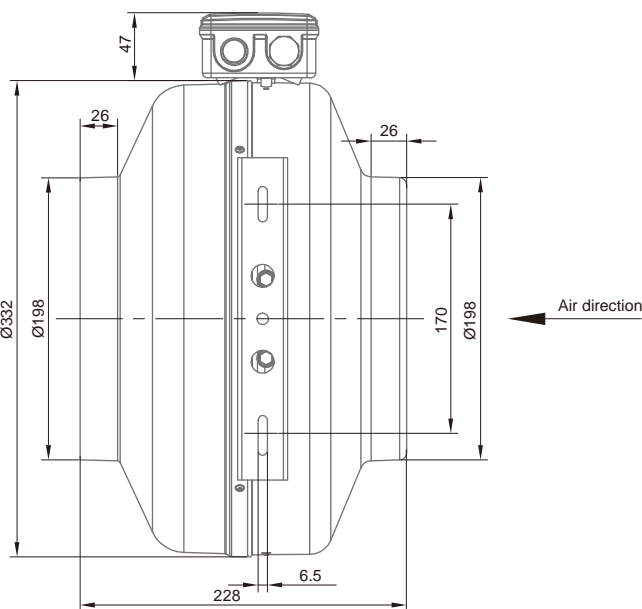
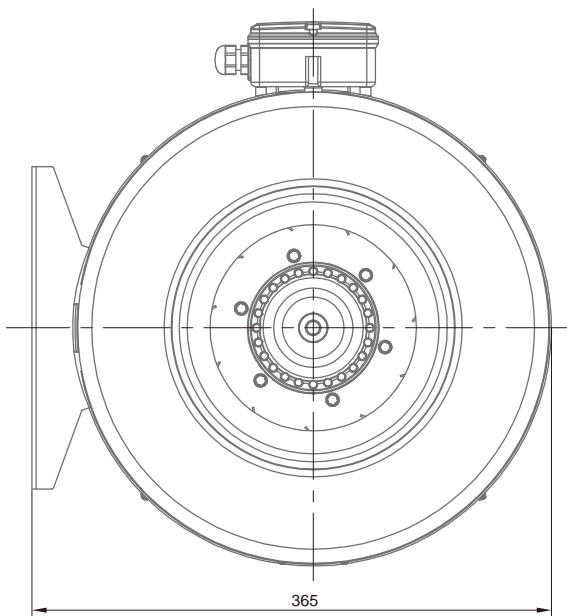

型号 Model	电压 Voltage (V)	频率 Frequency (Hz)	输入功率 Input Power (W)	电流 Current (A)	风量 Air Volume (m³/h)	转速 Speed (r/min)	电容 Capacitor (µF)	噪音 Noise [dB(A)]	允许最高环境温度 Max Environmental Temperature (°C)	重量 Weight (Kg)
YWF(K)2B225-200T02	120	60	200	1.7	930	2800	16	71	60	4.9
YWF(K)2E225-200T	230	50/60	150/200	0.7/0.95	900	2600/3000	4	65	50	4.9



### Flow Rate Curve

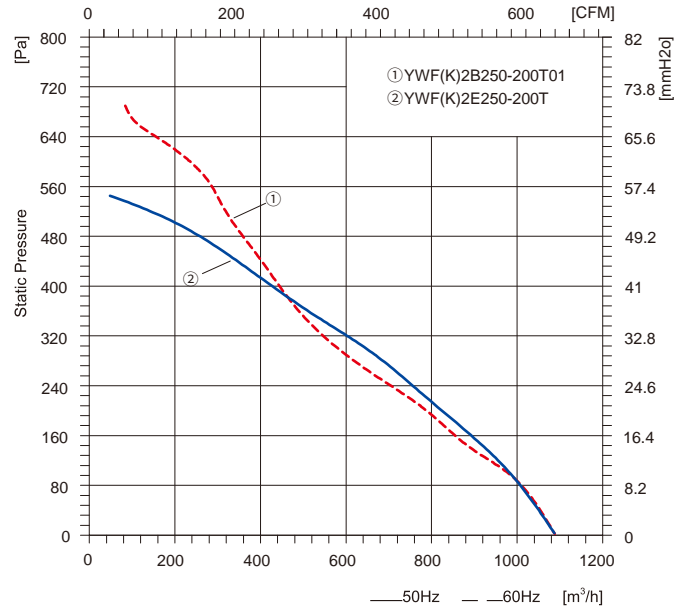

### 产品特点

电机技术: AC 外转子  
电机工作制: S1 连续工作制  
电机防护等级: IP54  
电机绝缘等级: F  
轴承: 免维护深沟球轴承  
风轮材料: 镀锌铁  
外壳材料: 镀锌钢板  
风轮旋向: 逆时针, 从引出线端看过去

### Product Characteristic

Motor technology: AC Outer rotor  
Mode of Operation: S1  
Protection Class: IP54  
Insulation Class: F  
Bearings: Maintenance-free ball bearings  
Impeller Material: Galvanised iron  
Housing Material: Galvanised sheet steel  
Rotation: C.C.W, seen on the leads

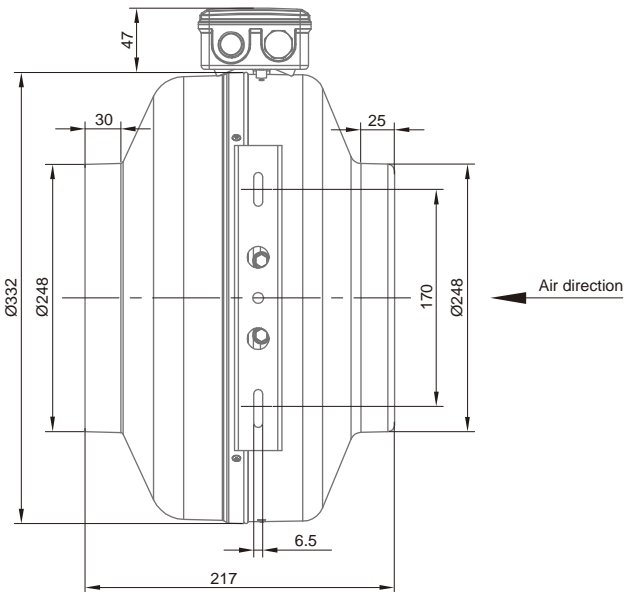
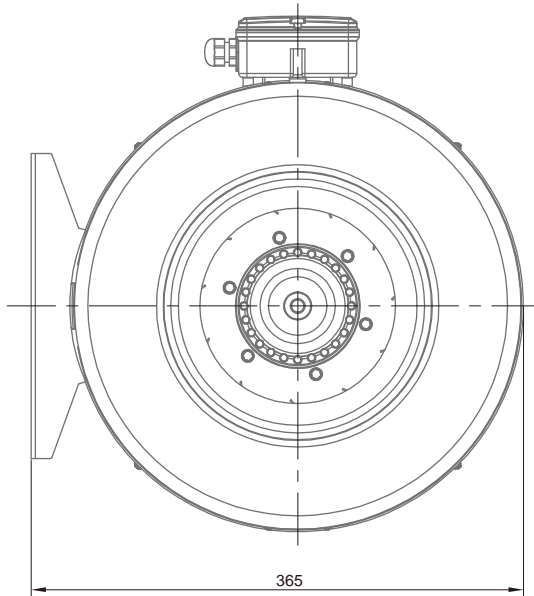

型号 Model	电压 Voltage (V)	频率 Frequency (Hz)	输入功率 Input Power (W)	电流 Current (A)	风量 Air Volume (m³/h)	转速 Speed (r/min)	电容 Capacitor (µF)	噪音 Noise [dB(A)]	允许最高环境温度 Max Environmental Temperature (°C)	重量 Weight (Kg)
YWF(K)2B250-250T01	120	60	240	2.1	1100	2500	19	73	60	5.1
YWF(K)2E250-250T	230	50	200	0.90	1080	2500	6	70	60	5.1