

Tangential blowers

QLN 65 with EC motor

Tangential blowers with electronically commutated EC-motors.

- integrated electronics
- blower speed variable via PWM (pulse width modulation) signal, optionally speed adjustment via 0 - 10 V analoguous voltage signal
- impeller diameter 65 mm
- horizontal or vertical mounting position with motor at the bottom
- protection class IP20, insulation class F
- permissible ambient temperature 0 – 60 °C

ebm-papst • Landshut



Nominal data		rated voltage VDC	air flow m ³ /h	max. pressure increase Pa	power input W	speed min ⁻¹	mass kg	Dimensions mm					
motor right*	motor left							a	b	c	d	e	f
QLN65/1200-2212	QLN65/0012-2212	24	160	110	14	2200	0,75	209	64,5	122	139	94	-
QLN65/1800-2212	QLN65/0018-2212	24	210	85	16	1850	0,8	269	64,5	182	199	154	69

*) *) Corresponding to dimensional drawing; Technical data are preliminary and valid at free air flow and rated voltage; subject to alterations

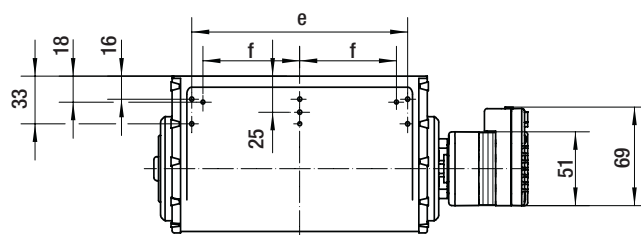

Characteristic curves

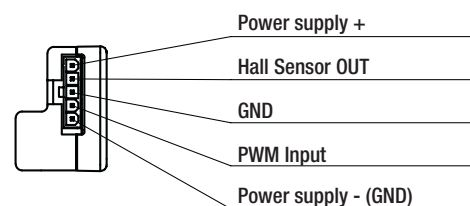
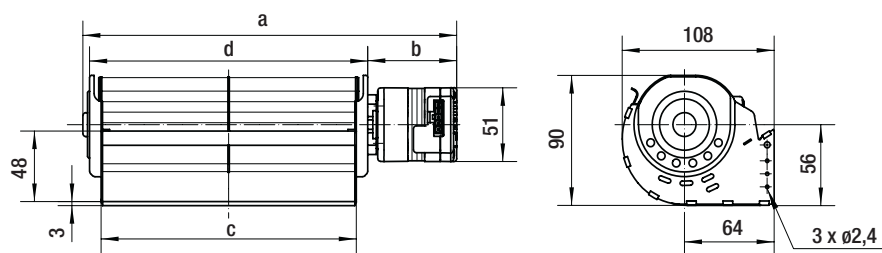
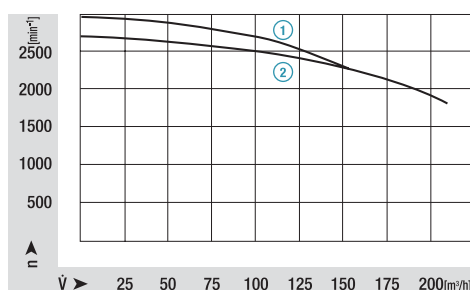
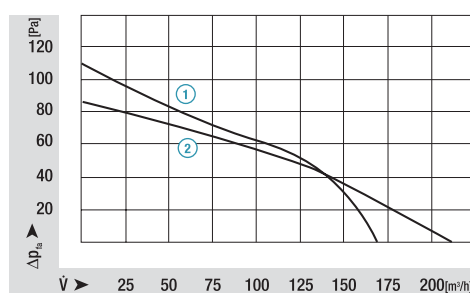

suitable for connector Molex Mini-Fit, Jr. (not part of delivery)
connector: order number 39-01-4050
female terminal: for example 39-00-0059

E-mail: zakaz@ventilatorry.ru